



Harthope Grove, DL14 0SQ
3 Bed - House - End Terrace
£80,000

ROBINSONS
SALES • LETTINGS • AUCTIONS • SURVEYS

Robinsons offer for sale this spacious three bedroomed end of terrace, located in Harthope Grove Bishop Auckland and located just a short distance from local amenities such as supermarkets, retail stores, popular high street stores and restaurants. There is an extensive public transport system in the area which allows for frequent access to neighbouring towns and villages as well as further afield places such as Durham and Darlington.

In brief the property comprises; an entrance lobby which leads through into the living room and kitchen/diner to the ground floor. The first floor contains the master bedroom, two further bedrooms and the bathroom. Externally this property contains an enclosed lawned garden to the rear with patio area with a separate garage to block.

To arrange a viewing please call Robinsons on 01388 458111

EPC Rating D / Council Tax Band A / Tenure - Freehold

GROUND FLOOR

Entrance Lobby

Lounge

15'9" x 15'1" (4.82 x 4.60)

Kitchen/Breakfast Room

15'0" x 8'6" (4.58 x 2.61)

FIRST FLOOR

Landing

Bedroom1

11'11" x 8'8" maximum (3.65 x 2.65 maximum)

Bedroom 2

8'7" x 8'7" (2.64 x 2.63)

Bedroom 3

Bathroom

External

Open plan lawned garden to front, fence enclosed rear garden and single garage to block.

AGENTS NOTES

Electricity Supply: Mains

Water Supply: Mains

Sewerage: Mains

Heating: Gas

Broadband: Basic 9Mbps, Superfast 33Mbps

Mobile Signal/Coverage: Average - good

Tenure: Freehold

Council Tax: Durham County Council, Band A (£1469 Min)

Energy Rating: D

Disclaimer: The preceding details have been sourced from the seller and OnTheMarket.com. Verification and clarification of this information, along with any further details concerning Material Information parts A, B & C, should be sought from a legal representative or appropriate authorities. Robinsons cannot accept liability for any information provided.



OUR SERVICES

Mortgage Advice

Conveyancing

Surveys and EPCs

Property Auctions

Lettings and Management

Strategic Marketing Plan

Dedicated Property Manager

Harthope Grove

Approximate Gross Internal Area
743 sq ft - 69 sq m

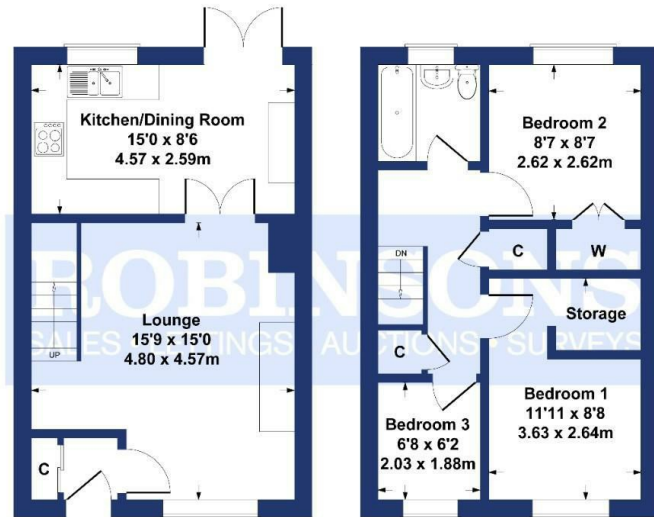

GROUND FLOOR

FIRST FLOOR

SKETCH PLAN FOR ILLUSTRATIVE PURPOSES ONLY

All measurements walls, doors, windows, fittings and appliances, their sizes and locations, are approximate only. They cannot be regarded as being a representation by the seller, nor their agent.

Produced by Potterplans Ltd. 2022

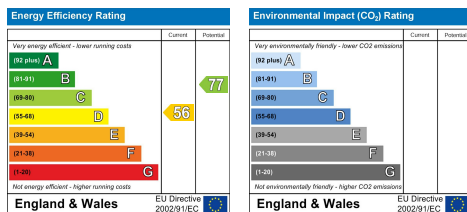

DURHAM

1-3 Old Elvet
DH1 3HL

T: 0191 386 2777 (Sales)

T: 0191 383 9994 (option1) (Lettings)

E: info@robinsonsdurham.co.uk

DURHAM REGIONAL HEAD OFFICE

19A old Elvet
DH1 3HL

T: 0191 383 0777

E: info@robinsonsdurham.co.uk

CHESTER-LE-STREET

45 Front Street
DH3 3BH

T: 0191 387 3000

E: info@robinsonscsls.co.uk

BISHOP AUCKLAND

120 Newgate Street
DL14 7EH

T: 01388 458111

E: info@robinsonsbishop.co.uk

CROOK

Royal Corner
DL15 9UA

T: 01388 763477

E: info@robinsonscrook.co.uk

SPENNYMOOR

11 Cheapside
DH16 6QE

T: 01388 420444

E: info@robinsonsspennymoor.co.uk

SEDGEFIELD

3 High Street
TS21 2AU

T: 01740 621777

E: info@robinsonssedgefield.co.uk

Every care has been taken with the preparation of these particulars, but they are for general guidance only and complete accuracy cannot be guaranteed. If there is any point, which is of particular importance please ask or professional verification should be sought. All dimensions are approximate. The mention of fixtures, fittings &/or appliances does not imply they are in full efficient working order. Photographs are provided for general information and it cannot be inferred that any item shown is included in the sale. These particulars do not constitute a contract or part of a contract.

Robinsons can recommend financial services, surveying and conveyancing services to sellers and buyers. Robinsons staff may benefit from referral incentives relating to these services.



ROBINSONS

SALES • LETTINGS • AUCTIONS • SURVEYS

120 Newgate Street, Bishop Auckland, DL14 7EH | Tel: 01388 458111 | info@robinsonsbishop.co.uk

www.robinsonsestateagents.co.uk